

Resolution RPC No. 1043

Amending the *Dane County Land Use and Transportation Plan* and *Water Quality Plan* by Revising the Mazomanie Urban Service Area Boundary and Environmental Corridors in the Village of Mazomanie, Dane County

WHEREAS, the Dane County Regional Planning Commission has adopted, amended and reaffirmed a *Dane County Land Use and Transportation Plan* and *Water Quality Plan*; and

WHEREAS, said plans delineate urban service areas as amended through August 2004; and

WHEREAS, the Village of Mazomanie has requested an addition to the Mazomanie Urban Service Area, and have based the request on the Village of Mazomanie Master Plan, adopted in 1997; and

WHEREAS, a staff analysis of the proposed amendment has been prepared, which indicates that the amendment is consistent with adopted regional plans and policies;

NOW, THEREFORE, BE IT RESOLVED that in accordance with §66.0309, Wis. Stats., and Sec. 208 of Public Law 92-500, the Dane County Regional Planning Commission amends the *Dane County Land Use and Transportation Plan* and *Water Quality Plan* by revising the Mazomanie Urban Service Area boundary and environmental corridors as shown on the attached map, based on the following findings and conclusions:

1. The proposal meets DCRPC criteria for urban service area amendments.
2. The amendment supports three of the goals and objectives of the *Dane County Land Use and Transportation Plan*, and is in conflict with one goal.
3. Stormwater quality measures such as wet retention basins will be installed, after review and approval by DCRPC and DCLCD staff, to mitigate the negative impacts of development to the maximum extent practicable, well beyond minimum county standards, to protect the water quality of Black Earth Creek.

Approval of this amendment is based on the land use and urban service plans submitted in support of this amendment, and conditioned on the Village of Mazomanie pursuing the following:

1. Submit a detailed stormwater management plan for the amendment area for DCRPC and DCLCD staff review and approval prior to development. Stormwater ponds are to be installed before other land disturbing activities in the amendment area. The plan should include the following:
 - Publicly managed facilities, or legally binding perpetual maintenance agreements for privately owned stormwater facilities.
 - Stormwater quality and quantity control for the entire amendment area to mitigate the adverse impacts of development to the maximum extent practicable (far exceeding the minimum county standards).
 - Stormwater quantity control to maintain post-development rates of runoff at pre-development levels for all storms up to and including the 100-year storm.

- Prevent increased erosion and flooding in downstream areas.
 - Designate stormwater management areas as environmental corridors.
 - Evaluation of stormwater pond and outlet capacity and performance under conditions of shallow groundwater and flooding in the area.
2. The 100-year floodplain should be designated as environmental corridors in the plat.

It is also recommended that the Village pursue the following:

1. Leave the floodplain area in open space.
2. Require that an archaeological survey be performed for the amendment area by a qualified archaeologist prior to other land disturbing activities. Provide 2 copies of the survey report to the SHS.

September 23, 2004

Date Adopted

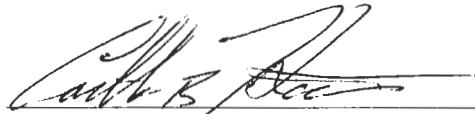

Carlton Hamre, Secretary

Mazomanie
USA



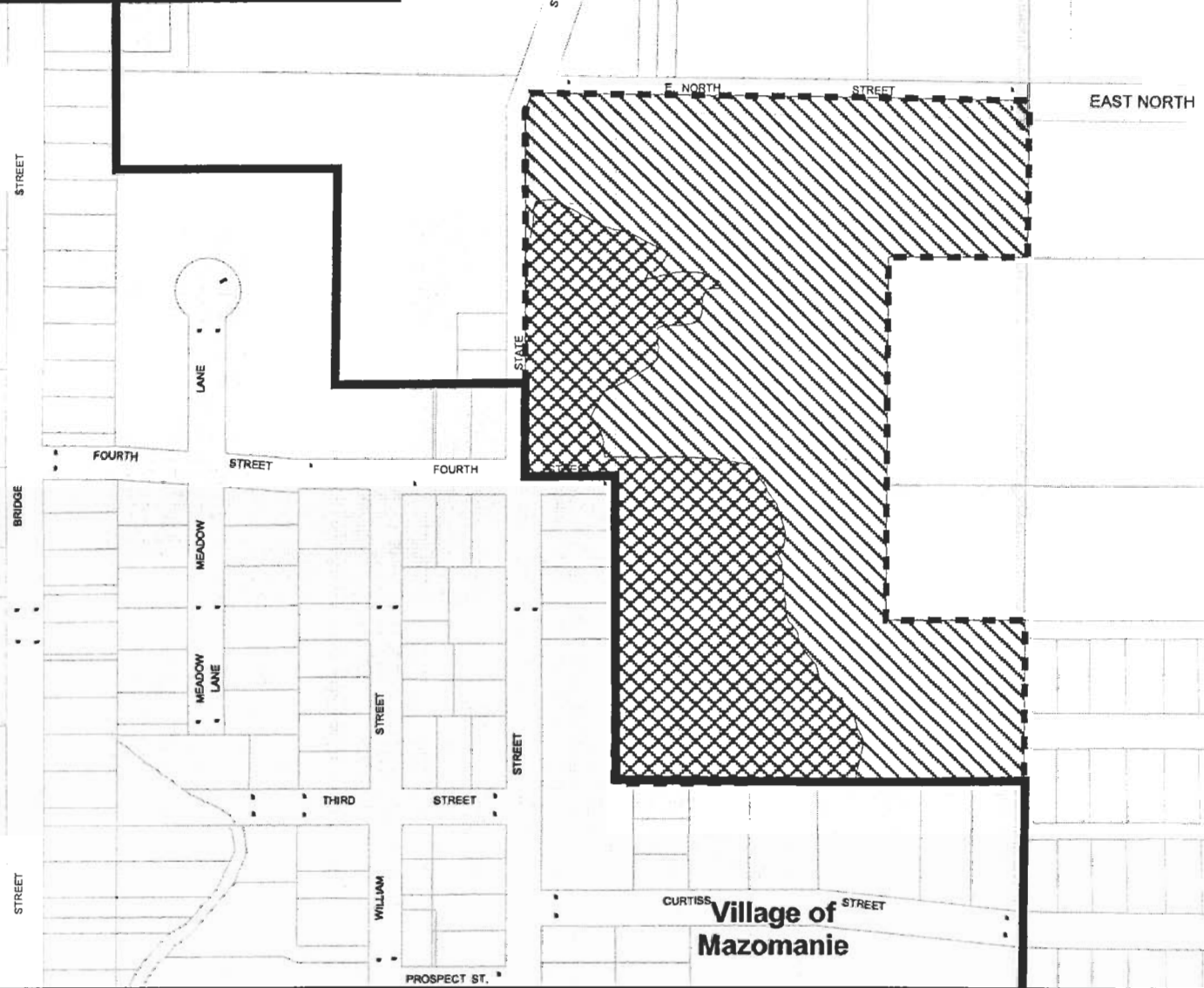

Amendment
Area

GEBRECHT ROAD

Town of Mazomanie



**Map 1 Amendment
to the Mazomanie
Urban Service Area,
Village of Mazomanie**

-  Service Area to be added
-  Proposed Environmental Corridor
-  Existing Urban Service Area Boundary
-  Proposed Urban Service Area Boundary
-  Incorporated Area

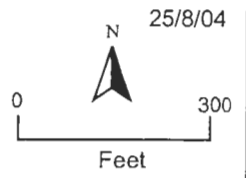

Prepared by staff
to the DCRPC.